

Middletown, CT : Commercial Property Record Card

[[Back to Search Results](#)]

[[Start a New Search](#)] [[Help with Printing](#)]

Search For Properties

Account	Map Block Lot	Street #	Street Name		
		180	JOHNSON ST	<input type="button" value="Search"/>	<input type="button" value="Reset Search"/>

Account	Card	Map-Block-Lot	Location	Zoning	State Class	Acres
R05667	11	20 12-2 13	180 JOHNSON ST	IRA	903 - City/Town Property	10

Owner Information

City Of Middletown
Po Box 1300
Middletown CT 06457

Property Picture

[No Picture Available]

Deed Information

Deed Book: 1229
Deed Page: 716
Deed Date: 2000/04/24

Building Information

Building No: 11
Year Built: 1934
No of Units: 0
Structure Type: Manufacturing
Grade: C
Living Units: 0
Identical Units: 1
Net Leasable Area: 183810

Valuation

Land: 412,800
Building: 858,670
Total: 1,271,470
Net Assessment: 890,030

Sales History

Book/Page	Date	Price	Type	Validity

Permit History

Date	Purpose	Price
2008/03/06	INT RENOV	5,600
2006/06/21	SHED	32,000

Out Building Information

Structure Code	Width	Lgth/SqFt	Year	RCNLD

Exterior/Interior Information

Levels	Size	Use Type	Ext. Walls	Const. Type	Partitions	Heating	A/C	Plumbing	Condition	Func. Utility	Unadj. RCNLD
01-01	1x7489	Light Manufacturing				Unit Heat	None	None			
01-01	1x4112	Warehouse				Unit Heat	None	None			

Building Sketch

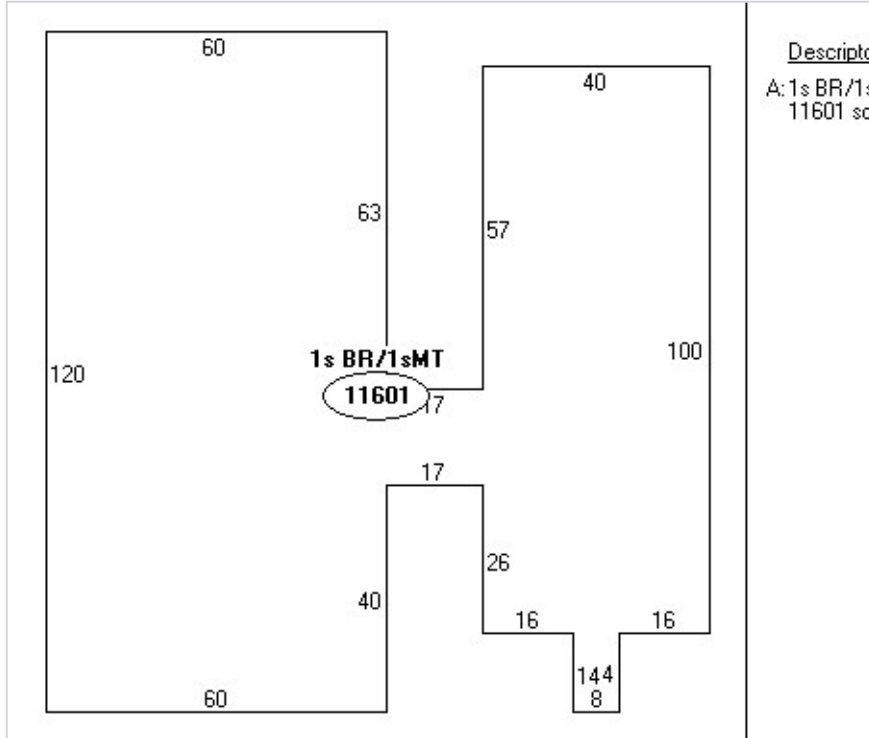

Notice

The information and assessments contained within this site are as of October 1, 2008. Please note that the assessed value does not reflect any exemptions, which may be applicable.

Currently All Values Have Not Been Finalized and Are Subject To Change.

The information delivered through this on-line database is provided in the spirit of open access to government information and is intended as an enhanced service and convenience for citizens of Middletown, CT.

The providers of this database: CLT, Big Room Studios, and the City of Middletown, CT assume no liability for any error or omission in the information provided here.

Comments regarding this service should be directed to: TaxAssessor@CityofMiddletown.com

