



- NOTES:**
1. THIS PLAN SUMMARIZES THE LIMITS OF WORK PROPOSED. FOR ADDITIONAL DETAIL, SEE GENERAL PLANS, SHEETS 1 THRU 6 OF 6.
 2. FOR APPROXIMATE LIMITS OF EXISTING WOODED AREAS, ROCK OUTCROPS AND OTHER SIGNIFICANT PHYSICAL FEATURES, SEE THE AERIAL PHOTOGRAPH ON DRAWING NO. C8.
 3. FOR EXISTING SLOPES GREATER THAN 25% AND OTHER TOPOGRAPHIC FEATURES, SEE EXISTING CONDITIONS PLAN, DRAWING NO. C1.
 4. IT IS ANTICIPATED THAT EXISTING WOODED AREAS WILL BE CLEARED AND GRUBBED TO APPROXIMATELY 10 FEET BEYOND PROPOSED TOPS AND BOTTOMS OF SLOPES.
 5. EXISTING BUILDINGS & FOUNDATIONS WITHIN THE LIMITS OF PROPOSED TOPS AND BOTTOMS OF SLOPES WILL BE DEMOLISHED.

ZONING TABLE	
ZONE	I3/SPECIAL INDUSTRIAL ZONE
USE	ELECTRICITY GENERATION & TRANSMISSION
LOT AREA	137.03 ACRES
LOT WIDTH	SEE EXISTING SITE PLAN
SIDE YARD	GREATER THAN 200'
BUILDING HEIGHT	95' MAXIMUM
COVERAGE	LESS THAN 30%
PARKING SPACES	25

LEGEND

- PAVED ROADWAY
- CRUSHED STONE
- PLANTED AREA
- SEDIMENTATION AREA
- WET POND AREA
- ROCK CUT
- SITE BOUNDARY
- FENCE

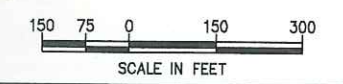

*40 acres
road
apply
elevation*

ISSUE	DATE	DESCRIPTION	BY	CHK'D
A	11-21-01	APPLICATION FOR LOCATION APPROVAL	ABB	RJL

KLEEN ENERGY SYSTEMS, LLC.
90 INDUSTRIAL PARK ROAD
MIDDLETOWN, CT. 06457

 <small>O&G INDUSTRIES, INC. 112 West St. Torrington, CT 06790-5418</small>	 <small>PB Power, Inc. A POWER & WATERWORKS COMPANY 24 HILBETH STREET, WATER, MASS. 02454</small>	 <small>TRC A Division of Parsons Brinckerhoff 5 WATERSIDE CROSSING WINDSOR, CT 06095</small>
--	--	--

**GENERAL PLAN
OVERALL SITE**

DR. JD	APPROVED	DATE	C11	DRAWING NO.	REV
DES.	PRINCIPAL IN CHARGE	DATE			
CHK.				SHEET 14 OF 58	

\\BOSC\CADD\26018A-MIDDLETOWN PROJ\CIVIL\SITE PLAN FILING\C11-PRES.DWG 11/30/01 10:11



- NOTES:**
1. THIS PLAN SUMMARIZES THE LIMITS OF WORK PROPOSED. FOR ADDITIONAL DETAIL, SEE GENERAL PLANS, SHEETS 1 THRU 6 OF 6.
 2. FOR APPROXIMATE LIMITS OF EXISTING WOODED AREAS, ROCK OUTCROPS AND OTHER SIGNIFICANT PHYSICAL FEATURES, SEE THE AERIAL PHOTOGRAPH ON DRAWING NO. C8.
 3. FOR EXISTING SLOPES GREATER THAN 25% AND OTHER TOPOGRAPHIC FEATURES, SEE EXISTING CONDITIONS PLAN, DRAWING NO. C1.
 4. IT IS ANTICIPATED THAT EXISTING WOODED AREAS WILL BE CLEARED AND GRUBBED TO APPROXIMATELY 10 FEET BEYOND PROPOSED TOPS AND BOTTOMS OF SLOPES.
 5. EXISTING BUILDINGS & FOUNDATIONS WITHIN THE LIMITS OF PROPOSED TOPS AND BOTTOMS OF SLOPES WILL BE DEMOLISHED.

ZONING TABLE	
ZONE	I3/SPECIAL INDUSTRIAL ZONE
USE	ELECTRICITY GENERATION & TRANSMISSION
LOT AREA	137.03 ACRES
LOT WIDTH	SEE EXISTING SITE PLAN
SIDE YARD	GREATER THAN 200'
BUILDING HEIGHT	95' MAXIMUM
COVERAGE	LESS THAN 30%
PARKING SPACES	25

LEGEND

- PAVED ROADWAY
- CRUSHED STONE
- PLANTED AREA
- SEDIMENTATION AREA
- WET POND AREA
- ROCK CUT
- SITE BOUNDARY
- FENCE

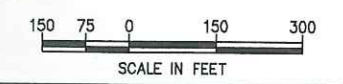

*40 acres
road
apply
element*

ISSUE	DATE	DESCRIPTION	BY	CHK'D
A	11-21-01	APPLICATION FOR LOCATION APPROVAL	ABB	RIL

KLEEN ENERGY SYSTEMS, LLC.
90 INDUSTRIAL PARK ROAD
MIDDLETOWN, CT. 06457

 <small>O&G INDUSTRIES, INC. 112 West St. Torrington, CT 06790-5418</small>	 <small>PB Power, Inc. A Power & Waterworks Company 74 HARTFORD STREET, SUITE 100, NEW HAVEN, CT 06510</small>	 <small>TRC Customer-focused solutions 5 WATERSIDE CROSSING WINDSOR, CT 06095</small>
--	---	--

**GENERAL PLAN
OVERALL SITE**

DR. JD	APPROVED	DATE	DRAWING NO.	REV
DES.			C11	
CHK.	PRINCIPAL IN CHARGE	DATE	SHEET 14	OF 58

MATCHLINE CONTINUED ON DRAWING C10

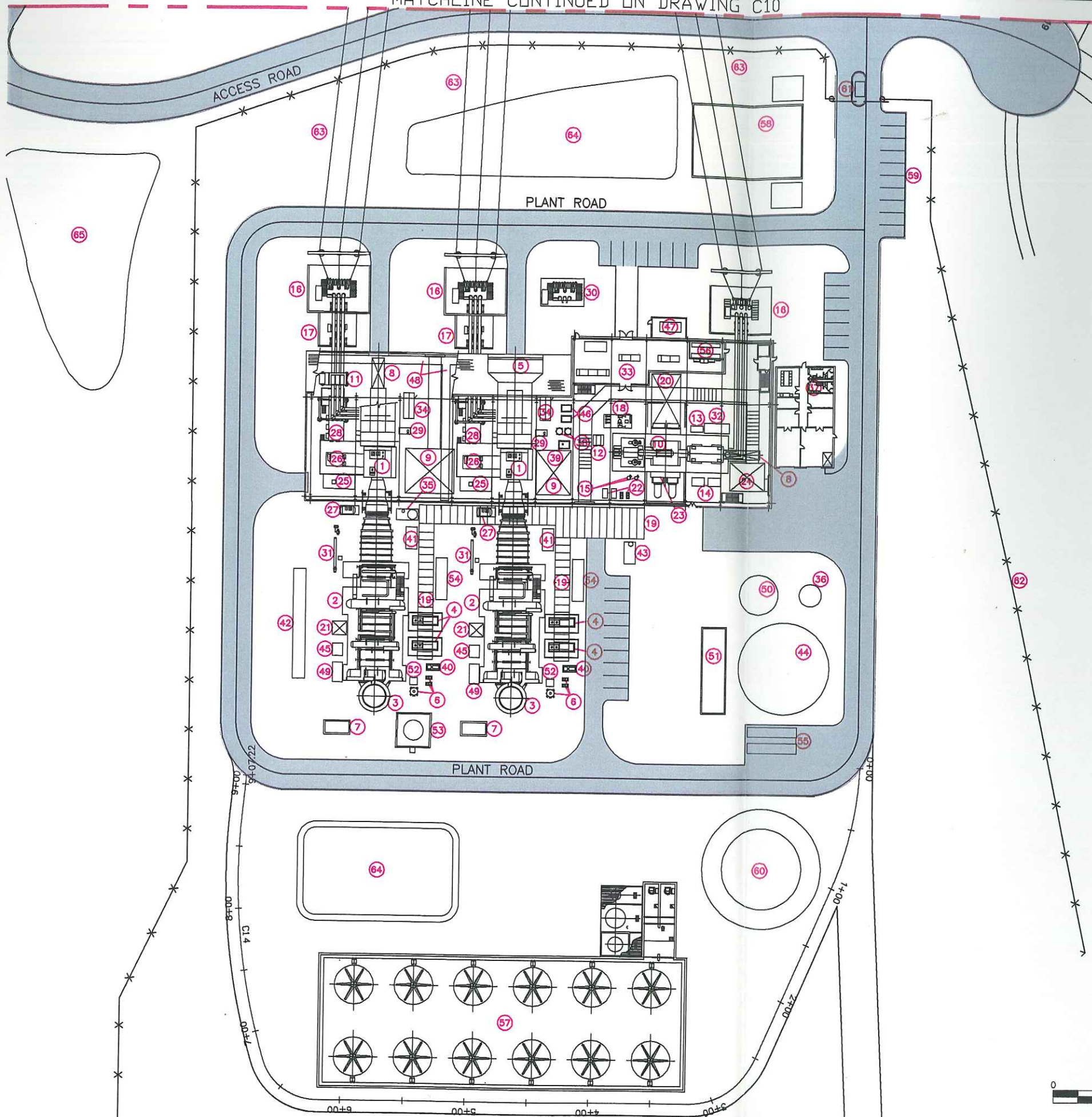

CN

- LEGEND:
1. COMBUSTION TURBINE
 2. HRSG
 3. HRSG STACK
 4. FEED PUMP (WITH SOUND ENCLOSURE)
 5. CT AIR INTAKE
 6. HRSG BLOWDOWN TANK AND PUMPS
 7. CEM BUILDING
 8. GENERATOR ROTOR REMOVAL AREA
 9. LAYDOWN AREA
 10. STEAM TURBINE
 11. GENERATOR BREAKER
 12. HYDRAULIC POWER UNIT
 13. EHC OIL UNIT
 14. CONDENSER VACUUM PUMPS
 15. CONDENSATE PUMPS
 16. MAIN-STEPUP TRANSFORMER
 17. AUXILIARY TRANSFORMER
 18. STEAM TURBINE LUBE OIL EQUIPMENT
 19. PIPE RACK
 20. CONDENSER TUBE REMOVAL
 21. SCR REMOVAL AREA
 22. CLOSED COOLING WATER PUMPS & PLATE HEAT EXCHANGERS
 23. MAIN CONDENSER
 24. EQUIPMENT REMOVAL AREA
 25. FUEL ATOMIZING AIR MODULE
 26. COMBUSTION TURBINE ACCESSORY MODULE
 27. FIRE PROTECTION CO2 SKID
 28. PACKAGED ELECTRICAL ELECTRONIC CONTROL CENTER (PEECC)
 29. AIR PROCESS SKID
 30. SPARE MAIN-STEPUP TRANSFORMER
 31. FUEL GAS HEATING EQUIPMENT
 32. EXCITER
 33. SWITCH GEAR ROOM
 34. COMBUSTION TURBINE LCI / EXCITER
 35. WATER WASH SKID
 36. NEUTRALIZATION TANK
 37. WAREHOUSE/MAINTAINANCE BUILDING
 38. INSTRUMENT AIR RECEIVER
 39. INSTRUMENT AIR DRYER
 40. LP PREHEATER RECIRC PUMP
 41. FALSE START DRAIN TANK
 42. BLACK START CTG
 43. AUXILIARY BOILER
 44. RAW WATER STORAGE TANK
 45. SCR SKID
 46. INSTRUMENT & SERVICE AIR COMPRESSORS
 47. EMERGENCY DIESEL GENERATOR
 48. ELECTRICAL TRENCH
 49. PHOSPHATE FEED SKID
 50. DEMIN. WATER STORAGE TANK
 51. RAW WATER, DEMIN WATER AND FIRE PUMP HOUSE
 52. BLOW/DOWN TANK SUMP
 53. AMMONIA STORAGE TANK
 54. MCC & HRSG TRANSMITTER AND DCS ENCLOSURE
 55. DEMIN. TRAILERS
 56. BATTERY ROOM
 57. COOLING TOWER
 58. GAS COMPRESSOR BUILDING
 59. PARKING AREA
 60. FUEL OIL TANK
 61. GUARD HOUSE
 62. PLANT FENCE
 63. 345kv OVERHEAD POWER CABLES
 64. SEDIMENTATION AREA
 65. WET POND

REFERENCES:
SUBSTATION PLAN

C10

M:\26018A-MIDDLETOWN PROJ\MECH\C9.DWG 11/30/01 13:56

ISSUE	DATE	DESCRIPTION	BY	CHK'D
A	11-21-01	APPLICATION FOR LOCATION APPROVAL	JEF	RJL

KLEEN ENERGY SYSTEMS, LLC.
90 INDUSTRIAL PARK ROAD
MIDDLETOWN, CT. 06457

 O&G INDUSTRIES, INC. 112 West Dr. Torrington, CT 06790-5418	 PB Power, Inc. A Parsons Brinckerhoff Company 20 MILLBURN ROAD, SUITE 200 MILLBURN, NJ 07041	 TRC Customer-Centered Solutions 5 WATERSIDE CROSSING WINDSOR, CT 06095
---	---	---

PLANT FACILITIES PLAN



DR. J.E.F.	APPROVED	DATE	DRAWING NO.	REV
DES. .			C9	A
CHK: R.J.B.	PRINCIPAL IN CHARGE	DATE	SHEET 12	OF 58